

# UCP04 Wiring Assembly

## Instructions

### ① Built-in Sensor

Assemble the pressure sensor button type into the ejector plate, etc. Attach the silicone tube provided with the cable and pinch it in the groove to prevent the cable from being broken or pinched.

If it is difficult to fix the cable with a silicone tube, it is desirable to fix the cable with aluminum tape, etc.

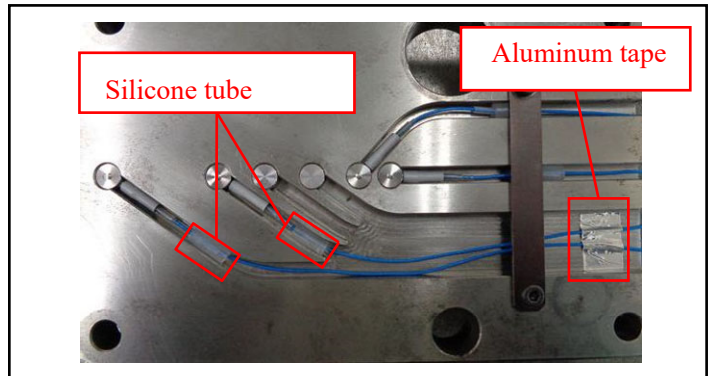

### ② Winding of Cables

Straighten the cable coming out of the mold and wind the cable together. At this time, adjust the cable windings for each sensor so that the connectors are aligned as much as possible. The diameter of the wound cable should be 40mm or less.

When the wound cable is bundled with aluminum tape or polyimide tape, it is easy to perform the following operations.

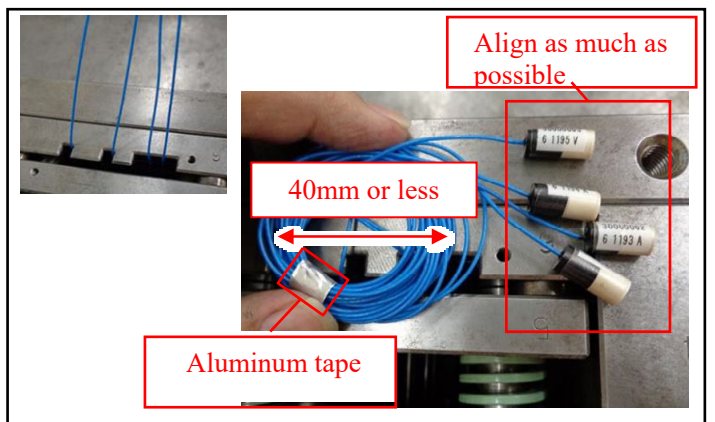

### ③ Installing the Sensor

Remove UCP04 plate and install the sensor. It is CH1 from the left. Be careful not to insert it incorrectly. At this time, record the information of the connected sensor in the field marked on the front of the plate.

Enter the lines in the field in the order of channel number, sensitivity classification, and pin diameter (pressure receiving area, etc.). For example When the sensor with the sensitivity category 61195V is connected to CH1 and the pin diameter is  $\phi 4$ , the sensor is as shown in the figure on the right.

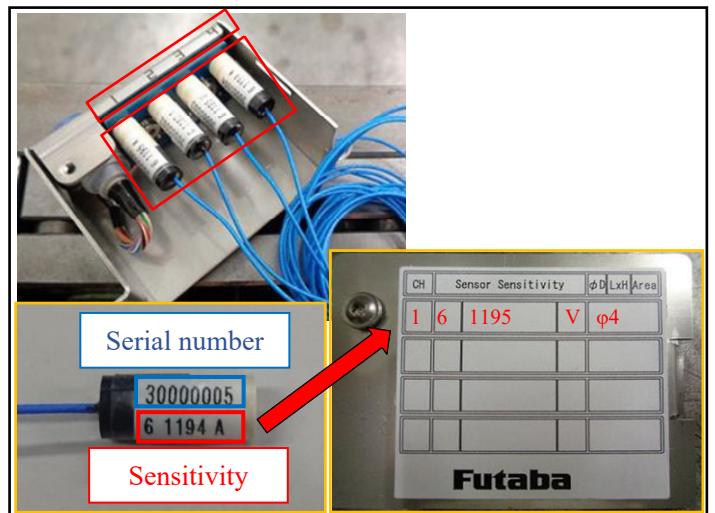

### ④ Cable storage

Store the grouped cables in the gap between the connector and the enclosure. At this time, be careful not to pull the cable from the connector side or the mold side.

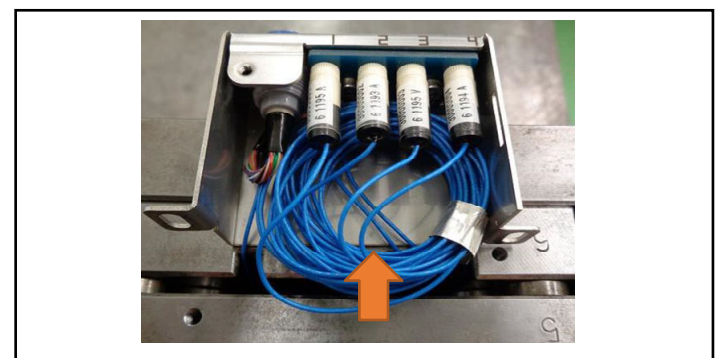

③ Mounting on molds

Screw UCP04 into the upright mold so that it does not get caught. If the cable protrudes from the enclosure, return to ② and rewind the cable so that it is smaller.

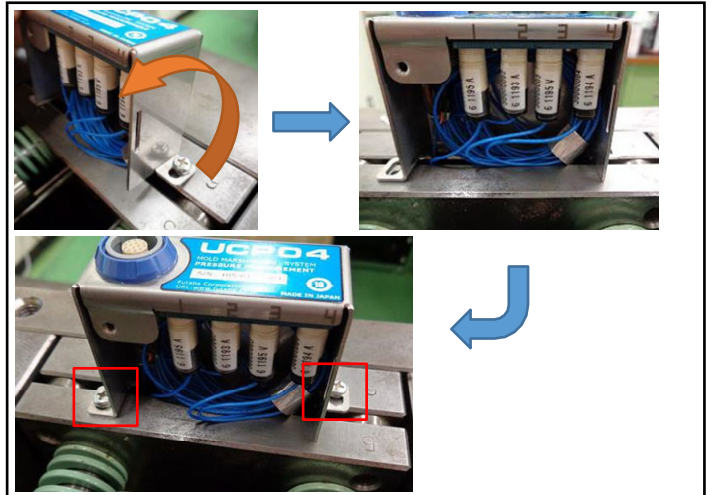

④ Placing the Front Plate

Close the plate by hooking the nail on the right side of the plate onto the slit of the enclosure, taking care not to pinch the cable. Then, align and turn the cap screw with the screw hole in the enclosure to completely install the plate. UCP04 installation is now complete.

To remove UCP04, follow the instructions in the reverse order of the installation. Be careful not to pull the cable when removing it.

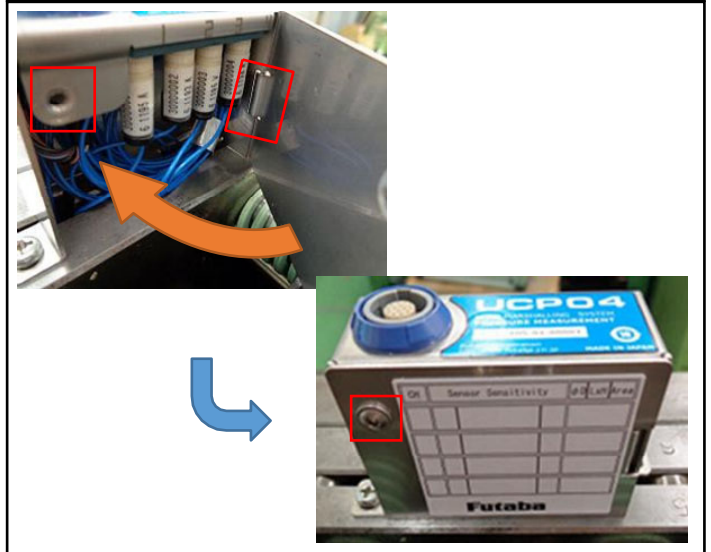

● UCP04 Dimensions (Unit: mm)

